



HYDRO
advance®

**Hydraulic Lifts
with no machine
room**



MEM
L I F T S



HydroAdvance: the next generation in hydraulic lifts

What is the HydroAdvance?

HydroAdvance is a state-of-the-art hydraulic lift offering these stand-out benefits:

- Highly compact, making more space available for productive use.
- Maximum simplicity.
- Safe & easy-access maintenance.
- More energy-efficient than conventional hydraulic lifts.

A highly competitive lift system specially designed for low-rise buildings and for conversions in existing buildings.

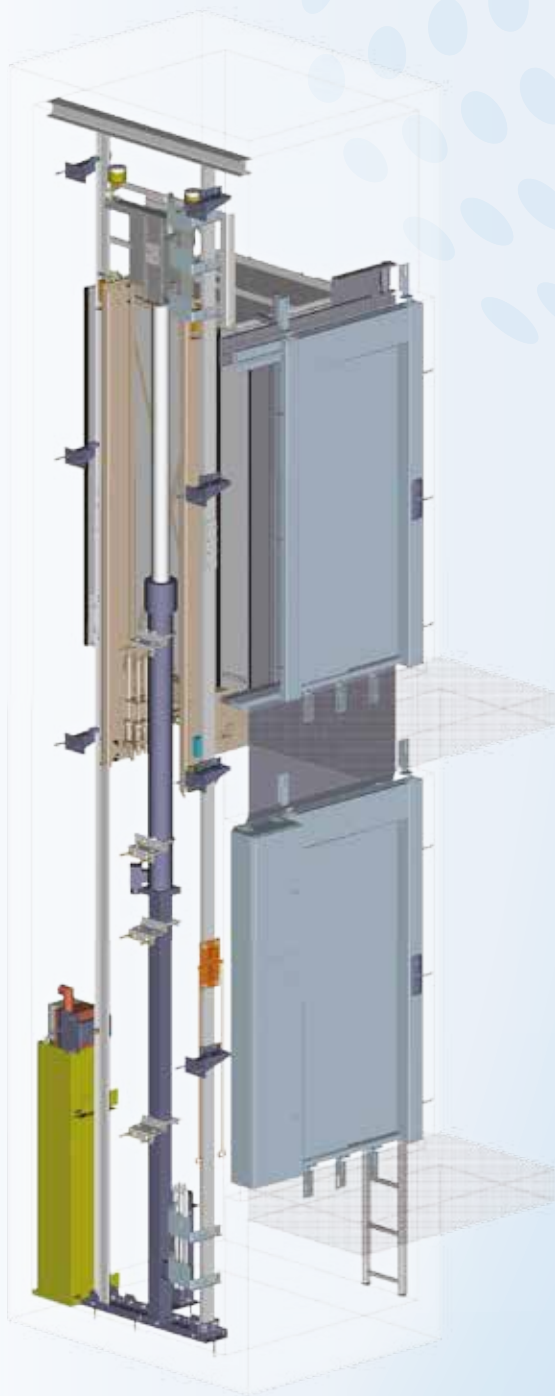

Residential

HydroAdvance[®]

Load capacity (range)	450Kg-1250Kg
Max. speed	0.63m/s (450, 630 & 1000Kg loads) 0.5m/s for 1250Kg load
Entrance Configurations	Single, double at 90° & 180°, and triple
Control system	Altamira 2
Interior design	Lift car 206, 406 & 410
Starts per hour	45
Maximum travel	with 1:1 roping: 2.8m across full range of loads; with 2:1 roping: 15.5m (450Kg), 13.5m (630Kg), 11.5m (1000Kg) & 10.5m (1250Kg)
Headroom	max: 3.4m, for lift car of 2.2m internal height, regardless of load beam
Pit depth	For 450 & 630Kg: 1100mm For 750Kg & above: 1200mm

HydroAdvance: flexible and versatile

Two outstanding options

The HydroAdvance® lift is both flexible and versatile. It is available in two distinct configurations to best suit the particular project - whether new-build or conversion.

- The control cabinet can be sited at anything up to 5 metres from the hydraulic drive unit.
- The cabinet can be sited on the lift shaft exterior and built into the wall adjacent to the landing door - so that maintenance work can be carried out from the landing.
- The cabinet can be sited inside the shaft - in this configuration a small additional cabinet is located at the bottom floor landing for use should manual passenger release be required.



Maximise your productive space

Removing the need for a machine room - by positioning the HydroAdvance® hydraulic drive unit in the lift shaft pit - means that all the space outside the shaft is freed up to be put to more productive use.

No machine room!

Why waste space? Simply siting the hydraulic drive unit inside the shaft saves all the space usually occupied by the machine room and control cabinet. If you choose to have the cabinet placed on the shaft exterior, this too gets rid of the need for a machine room as it is built into the wall by the landing door.

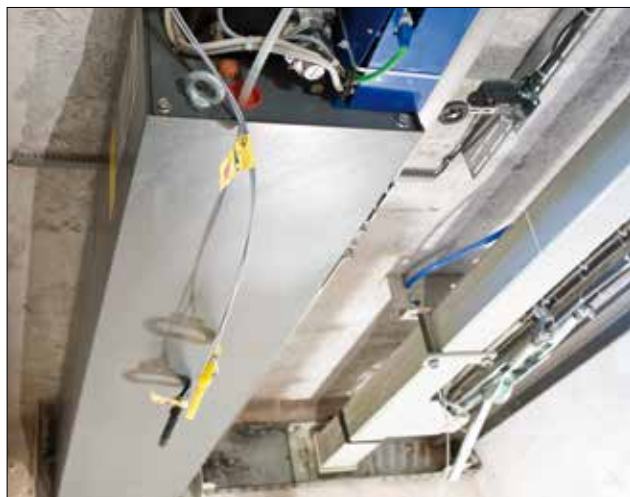

Optimum use of shaft

The HydroAdvance® does not use a counterweight or a traction unit - saving space inside the shaft and reducing required headroom height.

The HydroAdvance® is perfect for shafts which used to house an old-style traction lift, uses the available space to best advantage and frees up the old machine room for other purposes.

HydroAdvance: In the vanguard of hydraulic lift evolution

Our almost fifty years' experience of designing and manufacturing hydraulic lifts have led to our creation of a brand-new lift concept with unbeatable specifications. An evolutionary leap forward in the field of hydraulic lifts.

Evolution in ride comfort. HydroAdvance® moves with a smoothness and ride comfort comparable to that delivered by a VVVF drive system. Its valve bank with its electronic control unit and stepper motor optimizes speed curve regulation, independent of passenger load and oil temperature levels.

Evolution in silent & eco-friendly operation. The siting of its hydraulic drive unit within the shaft makes the HydroAdvance® an absolutely silent lift system, improving quality of life for all residents and users. And the oleodynamic system is designed to permit the use of non-contaminant eco-friendly fluids.

Evolution in energy efficiency. The HydroAdvance® is highly efficient and reduces energy consumption: in fact, its state-of-the-art hydraulic drive unit can save up to 40% of energy compared to a conventional drive unit.

Evolution in design & harmony. The HydroAdvance® is supplied with lift cars, operating panels, displays and signalling components to suit and embellish any design environment.

Evolution in safety provision. The HydroAdvance® has been designed to guarantee passenger safety, allowing passenger release to be carried out with ease and efficiency, and to make maintenance work significantly safer. Easy access to the pit and the fact that required adjustments can be made on an exclusive easy-to-use configuration control panel from outside the shaft makes maintenance staff's work both safe and straightforward.



A lift designed for lift professionals

HYDRO advance®

The HydroAdvance® is a highly competitive lift system, designed to cut the time required for installation and cut power supply costs.

The HydroAdvance® is simple to install and is delivered with clearly and comprehensively detailed plans and documentation.

The HydroAdvance® arrives on-site with highly detailed packing lists and clearly marked packaging, designed to facilitate installation work.

With the HydroAdvance® you get a state-of-the-art product and much more. We provide every customer with comprehensive technical support, both electrical and mechanical, original spare parts for all our lift systems, with guaranteed traceability using reference codes such as lift model number, plan number, control system number - or even just the site address.



**The HydroAdvance®
is a cutting-edge lift
system designed by lift
professionals
for lift professionals**



HydroAdvance: the best-equipped hydraulic lift

Supplied with the following equipment, as standard:

Control cabinet. Located next to the landing door on the bottom floor, 400x210x2220mm, with an epoxy finish. Integrated release facility.

Mechanical safety stop. Acting on car frame.

Hoist hook. Above the drive unit (500Kg).

Automatic doors. Two-panel, telescopic. EN 81-58 compliant.

Variable-speed door operator.

Lift car. Models 206, 406 and 410.

Car lighting. Various LED solutions and idle/standby modes.

Landing operating panel. The panel can be supplied engraved or unengraved.

Hydraulic drive unit. With electronic valve bank and stepper motor. Easy to configure using console.

ALTAMIRA 2 control system
Updated with new codes and interfaces which make installation, maintenance and passenger release even easier.



Lift car 206

- Finishes available in plastic laminates in a choice of colours.
- Car fronts in standard stainless steel.
- Upper and lower skirtings in standard stainless steel.
- Stainless steel handrails, available in various formats.
- Hardwearing floor finish in black rubber.
- 1/3-width mirror on back wall, at 300mm from floor.
- Direct lighting with LED spots.
- Stainless steel car operating panel, in standard or half-column format.

Lift car 406

- Available completely finished in stainless steel or in plastic laminates in a range of colours and textures.
- Lift car fronts in standard stainless steel.
- Upper and lower skirtings in standard stainless steel.
- Stainless steel handrails, available in various formats.
- Hardwearing floor finish in black rubber.
- 1/3-width mirror on back wall, at 300mm from floor.
- Direct lighting with LED light panel.
- Stainless steel car operating panel, in standard or half-column format.

Lift car 410

- Available completely finished in standard stainless steel or in stainless steel in a range of colours.
- Lift car fronts in standard stainless steel.
- Upper and lower skirtings in standard stainless steel.
- Stainless steel handrails, available in various formats.
- Hardwearing floor finish in black rubber or reinforced homogeneous vinyl.
- 1/3-width mirror on back wall, at 300mm from floor.
- Indirect fluorescent lighting with light panel.
- Stainless steel car operating panel, in standard or half-column format.

Interior styling

HALF-COLUMN OPERATING PANEL: BCE2



OPERATING PANEL: BCE1



LANDING OPERATING PANELS



BEE1



BEE2



BEE3



BEE4

DISPLAYS



DCTFT (7")

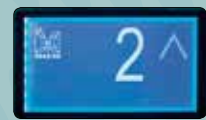

DCEGH (5")



DEEPV (3")

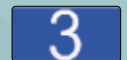

DCEPH (3")

IN-CAR PUSH-BUTTONS



PCEN



PCIN



PCEB



PCMT

LANDING SIGNALISATION SEMI-FLUSH MODULES



HLE0C/HLE0*



HLE1C



HLE2C



HLE3C



**HLE5



HLE4C



HLE6C/HLE6 ***

LANDING SIGNALISATION SURFACE-MOUNTED MODULES



HLE1

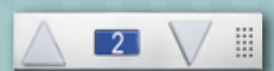

HLE3



HLE2



HLE4

* HLE0C fixed onto wall with built-in box & HLE0 fixed directly onto landing door lintel (visible fixings).

** HLE5: EN 81-70 compliant for cars with 50mm entrance return.

*** HLE6 fixed directly into landing door frame (invisible fixings).

Interior styling

Car 206



Car 406

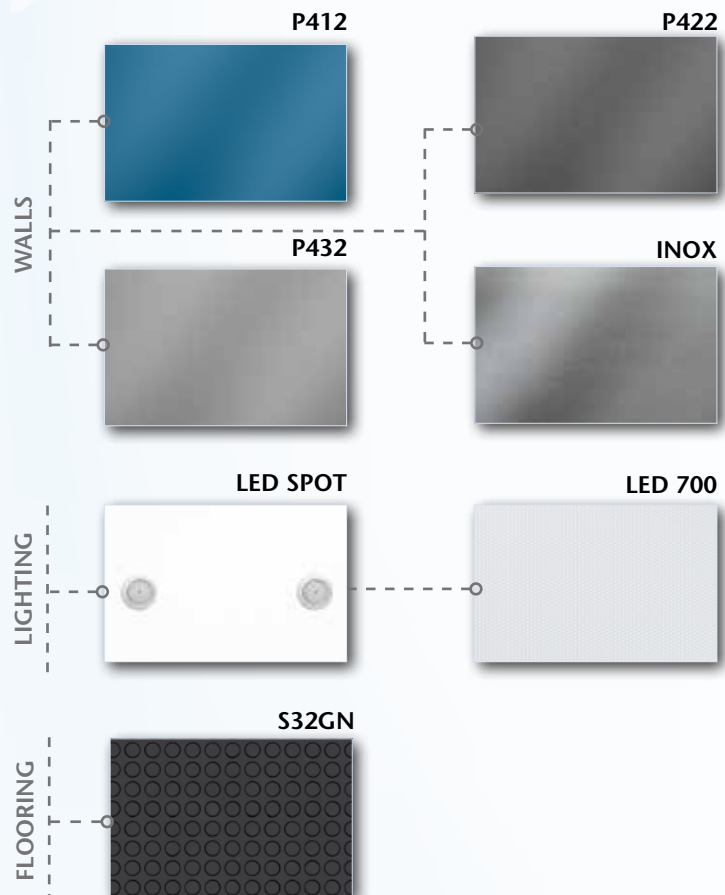

Interior styling

Car 410



WALLS

- PC443
- PC453
- PC463
- INOX

LIGHTING

- L750
- L760

FLOORING

- S32GN
- S62GG
- S52GN
- S42GB

HANDRAILS

- PSI1
- PSI2 EN81-70
- PSI3
- PSI4 EN81-70

Technical data

HydroAdvance[®] 450 - 630Kg

RATED LOAD (Kgs)	N° OF PEOPLE	ROPING RATIO	Max Rated Speed (m/s)	ENTRANCES N° / ANGLE	CAR SIZE		SHAFT SIZE		HEADROOM (car height 2200mm)	PIT	DOOR TYPE Max DW		
					WIDTH (A)	DEPTH (B)	WIDTH (C)	DEPTH (D)					
450	6	2,8 m at 1:1 15,5 m at 2:1	0,62 m/s	1 / 0°	1000	1200	1500	1450	3400mm above load beam	1100	2HT800		
					1000	1250	1500	1500					
					950	1200	1450	1450					
				2 / 180°	920	1300	1400	1660			2HT800 2HT700		
					870	1300	1350	1660					
					1000	1200	1550	1500					
2 / 90°	920	1200	1470	1500	2HT800 2HT700								
	900	1300	1450	1660									
600	8	2,8 m at 1:1 13,5 m at 2:1	0,62 m/s	3-entrance	1100	1300	1600	1550			3400mm above load beam	1100	2HT800 2HT900
					1060	1350	1550	1710					
					1060	1350	1610	1650					
					1000	1350	1550	1710					
630	8	2,8 m at 1:1 13,5 m at 2:1	0,62 m/s	3-entrance	1100	1400	1600	1650	3400mm above load beam	1100			2HT800
					1100	1400	1600	1760					
					1100	1400	1650	1700					
					1100	1400	1650	1760					

■ Car EN 81-70 compliant (Type 1 & Type 2)

□ Car: minimum possible

Shaft tolerance: - 0mm, + 50mm

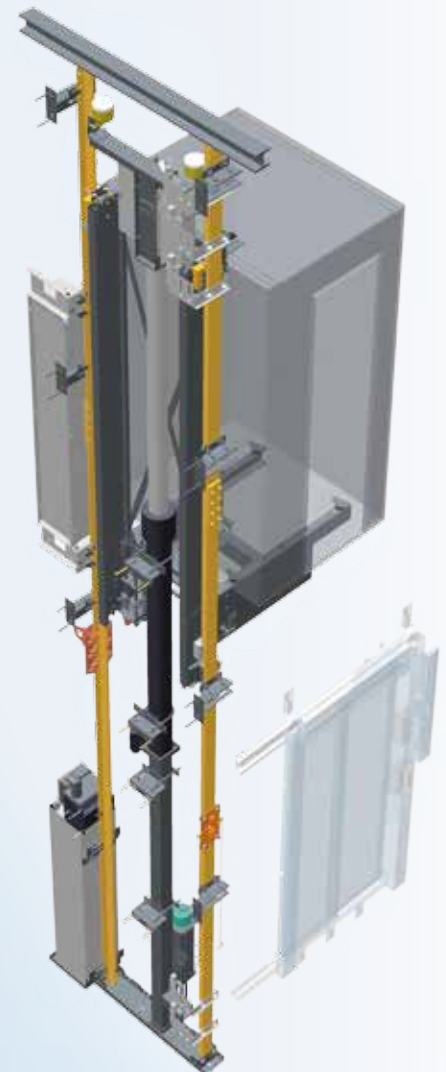
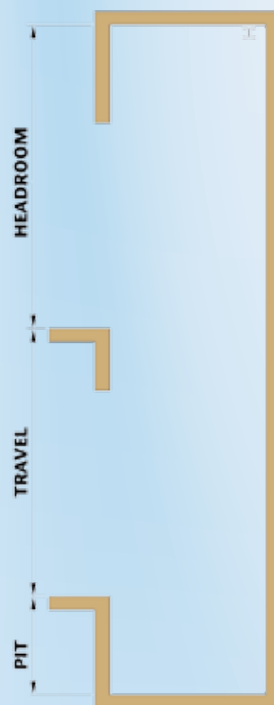
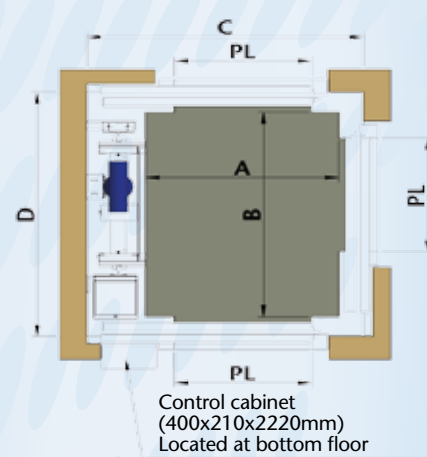

HydroAdvance® up to 1250Kg



RATED LOAD (Kgs)	N° OF PEOPLE	ROPING RATIO	Max Rated Speed (m/s)	ENTRANCES N° / ANGLE	CAR SIZE		SHAFT SIZE		HEADROOM (car height 2200mm)	PIT	DOOR TYPE Max DW
					WIDTH (A)	DEPTH (B)	WIDTH (C)	DEPTH (D)			
1000	13	2,8 m at 1:1	0,62 m/s	1 / 0°	1100	2100	1650	2350	3400mm above load beam	1200	2HT900
					1400	1600	1950	1900			2HT1000
				2 / 180°	1100	2100	1650	2460			2HT900
					1200	1750	1750	2110			2HT1000
		2 / 90°		1400	1600	2020	1900	2HT900			
				1240	1700	1860	2000	2HT1000			
		3-entrance		1100	2050	1720	2410	2HT900			
				1200	1750	1820	2110	2HT1000			
1250	16	2,8 m at 1:1	0,5 m/s	1 / 0°	1200	2300	1750	2550	3400mm above load beam	1200	2HT1000
					1400	1800	1950	2050			2HT1000
				2 / 180°	1200	2300	1750	2660			2HT1000
					1400	1800	1950	2160			2HT1000
		2 / 90°		1400	1760	2020	2050	2HT1000			
				1400	1800	2020	2160	2HT1000			
		3-entrance		1400	1800	2020	2160	2HT1000			
				1400	1800	2020	2160	2HT1000			

■ Car in all cases EN 81-70 compliant (Type 2)
Shaft tolerance: - 0mm, + 50mm

Cabinet: shaft placement options

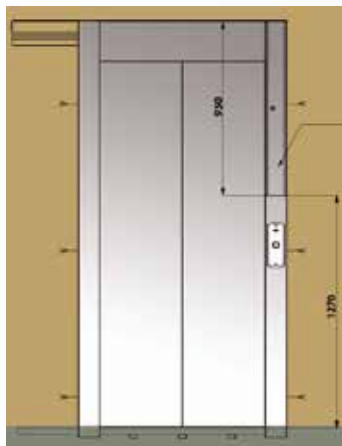

Rescue cabinet above doorway



Built-in rescue cabinet
Height variable as req'd

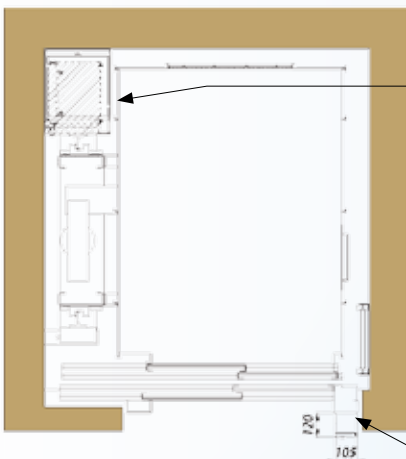

Cabinet in shaft
(300x250x1600mm)
Site: 2nd floor landing

Cabinet in shaft
(300x250x1600mm)
Site: 2nd floor landing

Rescue cabinet in stainless steel
(105x120x950mm)
Site: bottom floor

Rescue cabinet
(105x120x950mm)
Site: bottom floor

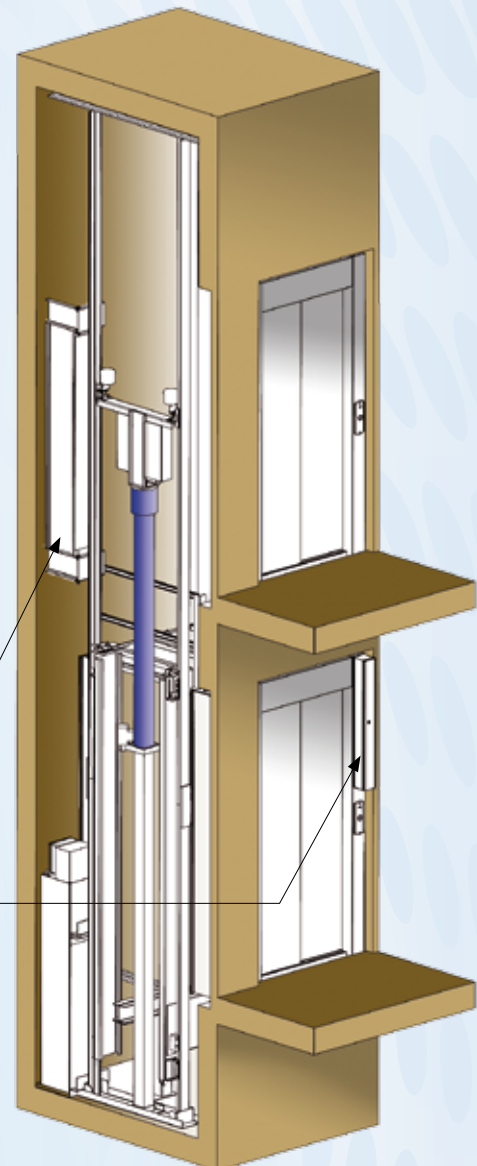



All the information contained in this catalogue is the property of IMEM Lifts. The partial or total reproduction of its contents without the prior written authorisation of IMEM S.L. is strictly forbidden. The distribution or copying of photographs, logos or any other graphic material contained herein is strictly forbidden, IMEM Lifts being the acknowledged sole proprietor of all intellectual property rights pertaining.

IMEM Lifts reserves the right to modify the specifications, options and colours presented in this catalogue. All the illustrations shown have a purely indicative character. The colours and materials of the delivered products may differ slightly from those pictured in the catalogue.

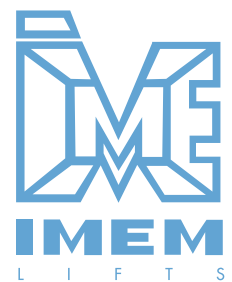

EXPORT DEPARTMENT

Website: www.imemlifts.com
 Email: comex@imem.com

C/ Adarzo 167-B.
 39011 Peñacastillo
 Santander, Spain

Tel: (00 34) 942 34 60 20
 Fax: (00 34) 942 35 53 64



EFQM
 Business
 Excellence



ISO 9001
 Quality
 Management



OHSAS 18001
 Occupational
 Health & Safety
 Management



ISO 14001
 Environmental
 Management